

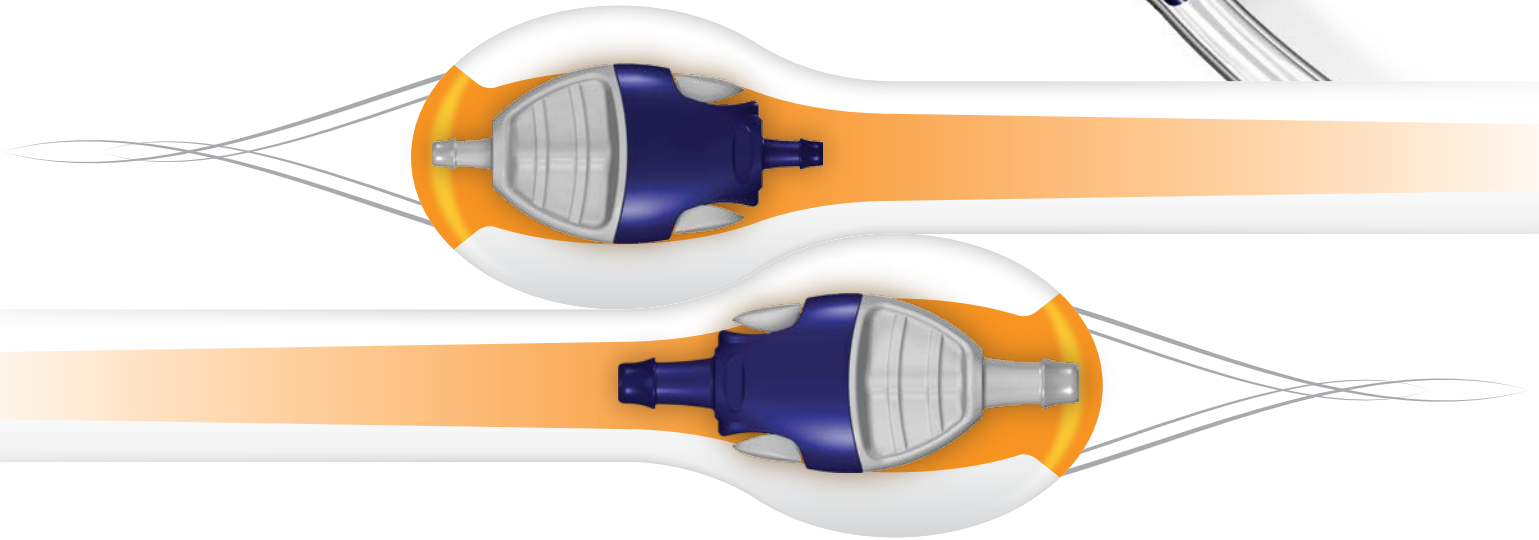

Nordson MEDICAL introduces a new concept in quick connect fittings for small-bore applications. The SBL Series connector system is so intuitive that users just automatically know how to operate it the minute they pick it up.

THE SBL SERIES

QUICK CONNECTS



FEATURES

Ergonomic Design

Versatile

Nylon & Buna-N Materials

Lubricated O-ring

BENEFITS

Easy and intuitive to connect and disconnect

Two sizes fit 1/8" and 3/16" tubing IDs
180° of tube orientation

Gamma radiation stable, EtO compatible

Long service life

SPECIFICATIONS

Materials: Body, Nylon. O-ring, Buna-N

Tubing Sizes: 1/8" (3.2 mm), 3/16" (4.8 mm)

Leak Resistance: <.007 psi/0.05 kPa/sec.

Minimum Bore: 0.96"

Tensile Pull Load: 27 lbs

Working Pressure: Up to 25 psi

Life Cycle Tested: Up to 1,500 times

For more information and samples, please visit www.nordsonmedical.com



SBL Series quick connect fittings are cost effective and designed to meet your needs for a reusable component for small-bore applications in all fluid delivery areas. Contact us today for free samples and make this exciting new fluid link part of your next design.

THE SBL SERIES QUICK CONNECTS

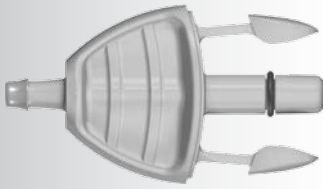

SBLM013-001
Side Latch Quick Connect Male
500 Series Barb
1/8" (3.2 mm) ID Tubing, Grey Nylon
Dimensions A: .929" B: 2.037" C: .468"
Also available in Blue Nylon - SBLM013-002



SBLF013-CM030
Side Latch Quick Connect Female
500 Series Barb
1/8" (3.2 mm) ID Tubing, Blue Nylon
A: .935" B: 2.037" C: .467"
Also available in Grey Nylon - SBLF013-8B

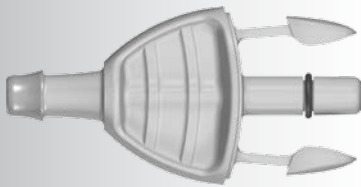

SBLM035-001
Side Latch Quick Connect Male
500 Series Barb
3/16" (4.8 mm) ID Tubing, Grey Nylon
A: .929" B: 2.421" C: .468"
Also available in Blue Nylon - SBLM035-002



SBLF035-CM030
Side Latch Quick Connect Female
500 Series Barb
3/16" (4.8 mm) ID Tubing, Blue Nylon
A: .935" B: 2.421" C: .467"
Also available in Grey Nylon - SBLF035-8B

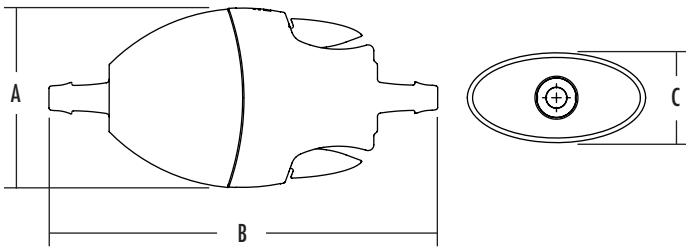

Pressure Drop vs. Flow Rate

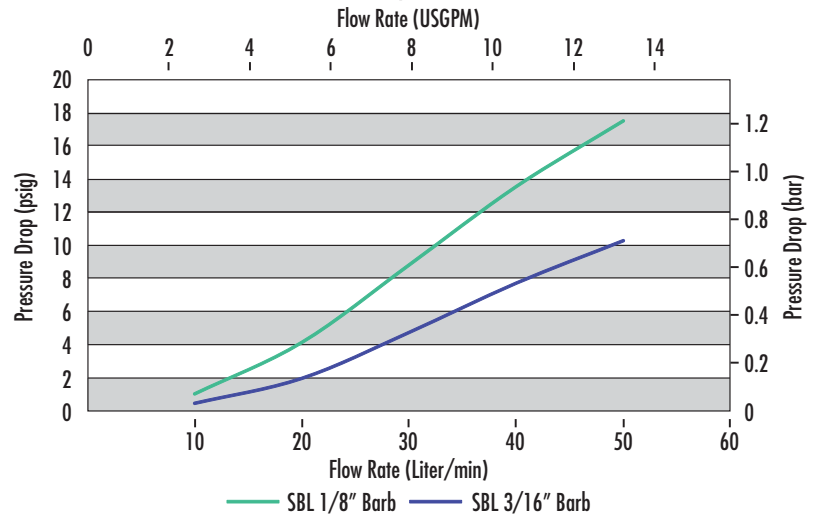

The data presented here are for reference only. They are not presented as a specification guideline. As your application conditions are beyond Nordson MEDICAL's control, it is imperative that you test products in their specific environments to determine suitability for a particular use. For further information on Nordson MEDICAL warranties, please review section 10 of the "Terms and Conditions of Sale" on the Nordson MEDICAL website at http://www.nordsonmedical.com/technical/orders/vp_terms.pdf or Nordson MEDICAL's most recent catalog.

United States of America

3325 South Timberline Road
Fort Collins, CO 80525
U.S.A.

Phone: +1 (970) 267.5200
Toll Free: (888) 404.5837

sales@nordsonmedical.com
www.nordsonmedical.com

Asia Pacific

Rm. 206, 2/F, Tung Ming Building,
40-42 Des Voeux Road Central
Hong Kong

Phone: (852) 6808.9862
Fax: (852) 2470.9802

cnsales@nordsonmedical.com
www.nordsonmedical.com

MedNet - European Partner

Borkstrasse 10
48163 Münster,
Germany

Phone: +49 251 32266-0
info@medneteuropa.com

Belgium Netherlands
Czech Republic Norway
Denmark Poland
Finland Sweden
Germany Turkey
Hungary Israel
Luxembourg

Promepla - European Partner

9 Ave Prince Albert II
MC98000
MONACO

Phone: +377 97 98 42 32
sales@promepla.com

Austria
France
Italy
Monaco
Portugal
Spain
Switzerland

The West Group - European Partner

Aston Road
Waterlooville, Hants.
PO7 7XJ

Phone: +44 23 9226 6031
sales@westgroup.co.uk

Ireland
United Kingdom



IN-STOCK

Components & Tools



Experts in Medical Device Design, Manufacturing & Component Technologies

Browse our online store, with more than 7,000 stock components and technologies, most ready to ship within 24 hours.



Components & Technologies



Catheters & Cannulae

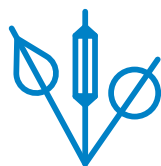

Medical Balloons

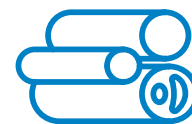

Medical Tubing

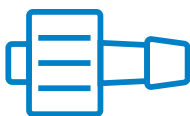

Fluid Management Components

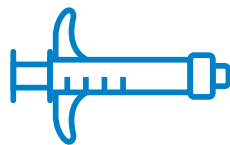

Biomaterial Delivery Devices



Nitinol Components