

REVISIONS						
SHEET	ZONE	REV.	ECO	DESCRIPTION	DATE	APPROVED
1	ALL	A	50242	INITIAL RELEASE	10/18/2018	HRC

LATCH HARDWARE,
(STAINLESS STEEL)

SOCKET,
(BRASS, NICKEL AND
CHROME PLATED)

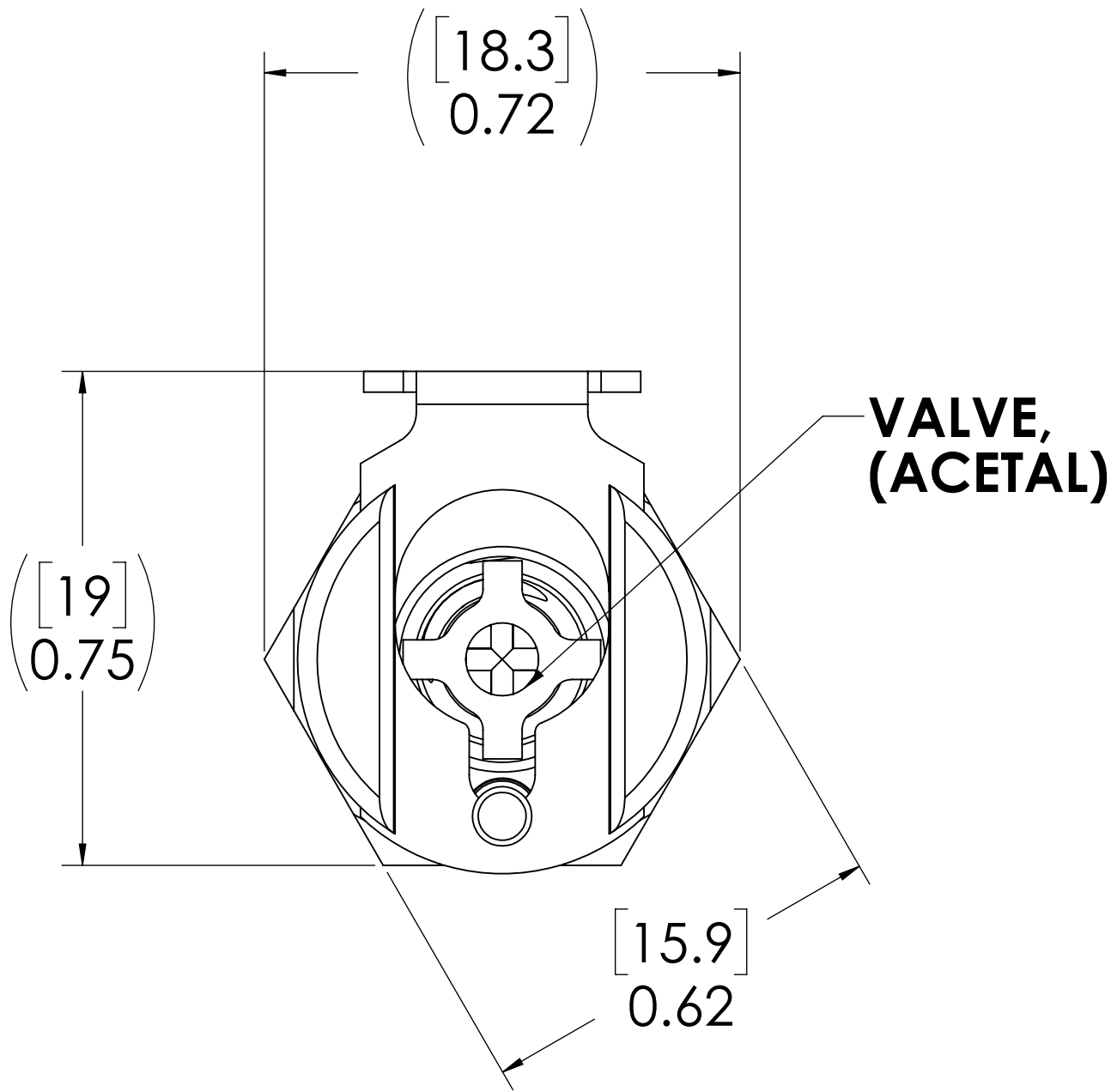
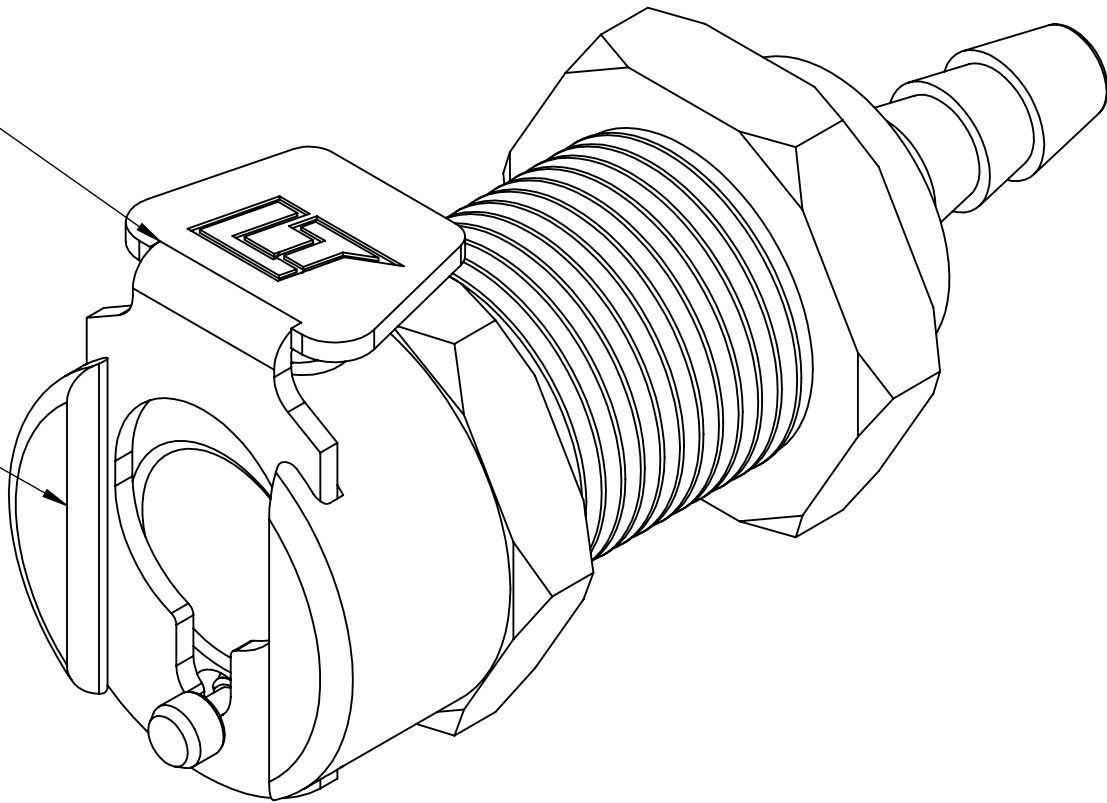

VALVE SPRING,
INTERNAL
(STAINLESS STEEL)

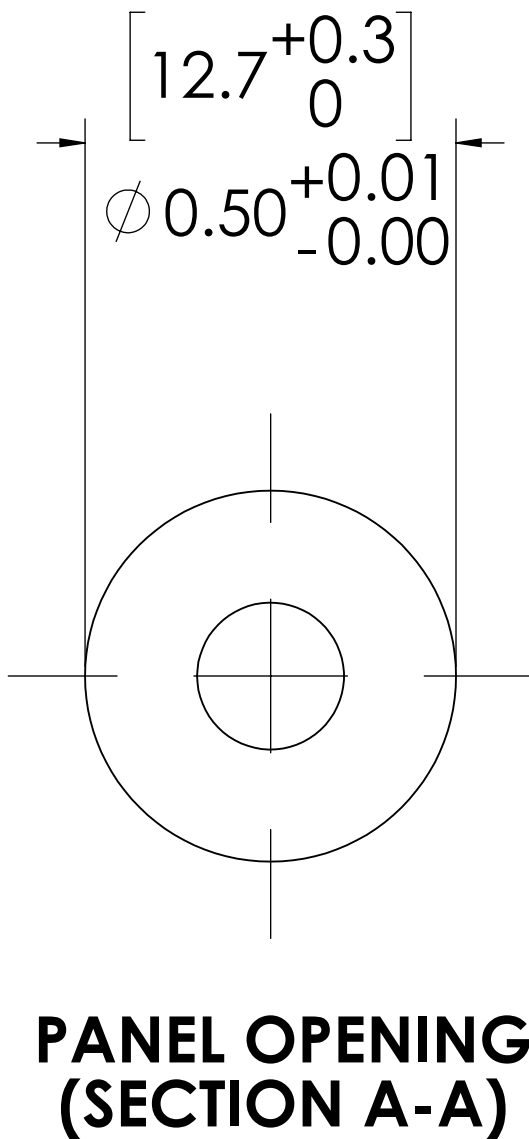
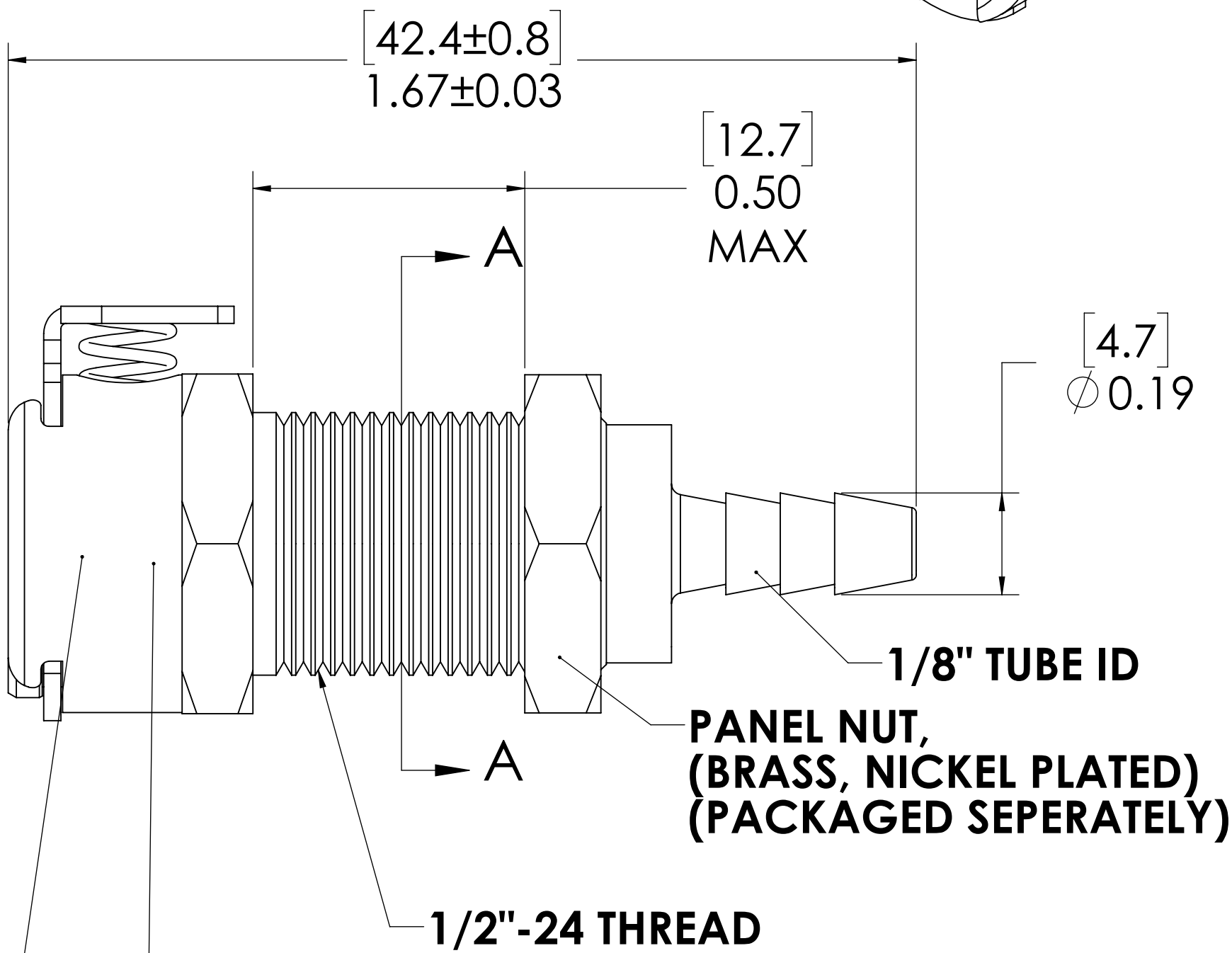

- NOTES:**
- MATERIAL: BRASS
 - FINISH: CHROME
 - O-RING MATERIAL: BUNA-N
 - O-RINGS LUBRICATED WITH FOOD GRADE SILICONE OIL, 350 CST.

FOR REFERENCE ONLY

UNLESS OTHERWISE SPECIFIED:				LINKTECH		
DIMENSIONS ARE IN INCHES TOLERANCES: FRACTIONAL ±1/32 ANGULAR, MACH ±0.5 BEND ±2 ONE PLACE DECIMAL ±0.1 TWO PLACE DECIMAL ±0.01 THREE PLACE DECIMAL ±0.005 TWO PLACE DUAL (mm) [±0.12]	DRAWN	CGS	1/26/18	PART NO: 20CBV-SB3-02		
	CHECKED	HRC	1/26/18			
	ENG APPR.	HRC	10/18/18	DESCRIPTION: LinkTech 20CB Series Panel Mt. Female, Valved, 1/8" HB, Chrome Brass		
	MFG APPR.	BDB	10/18/18			
PROPRIETARY AND CONFIDENTIAL THE INFORMATION CONTAINED IN THIS DRAWING IS THE SOLE PROPERTY OF LINKTECH LLC. ANY REPRODUCTION OR DISCLOSURE IN PART OR AS A WHOLE WITHOUT THE WRITTEN PERMISSION OF LINKTECH LLC IS STRICTLY PROHIBITED.	PRODUCTION	LS	10/18/18	SIZE	DWG. NO.	REV
	COMMENTS:			C	20CB200192	A
				SCALE: NTS	WEIGHT:	SHEET 1 OF 1