

REVISIONS						
SHEET	ZONE	REV.	ECO	DESCRIPTION	DATE	APPROVED
1	ALL	A	50253	2017 FORMAT UPDATE	3/8/2018	HRC

PLUG BODY,
(POLYPROPYLENE)

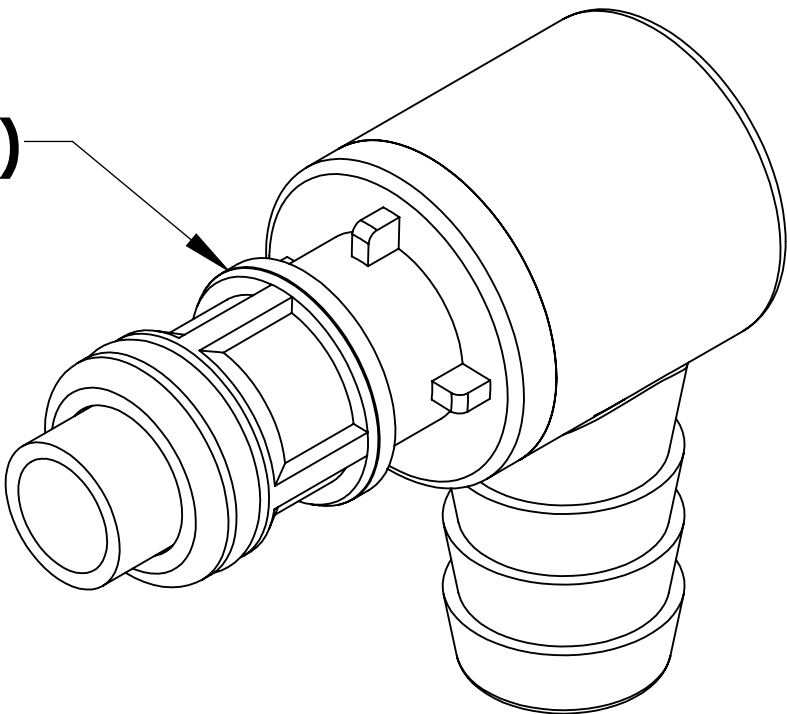

VALVE,
(POLYPROPYLENE)

3/8' TUBE ID

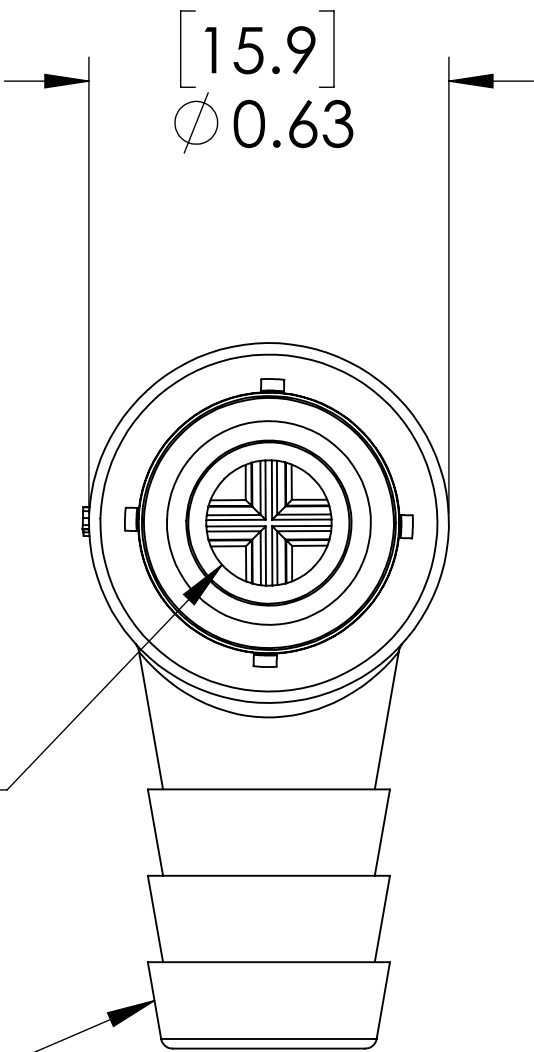

O-RING,
EXTERNAL
(EPDM)

O-RING,
INTERNAL
(EPDM)

SPRING,
INTERNAL
(STAINLESS STEEL)

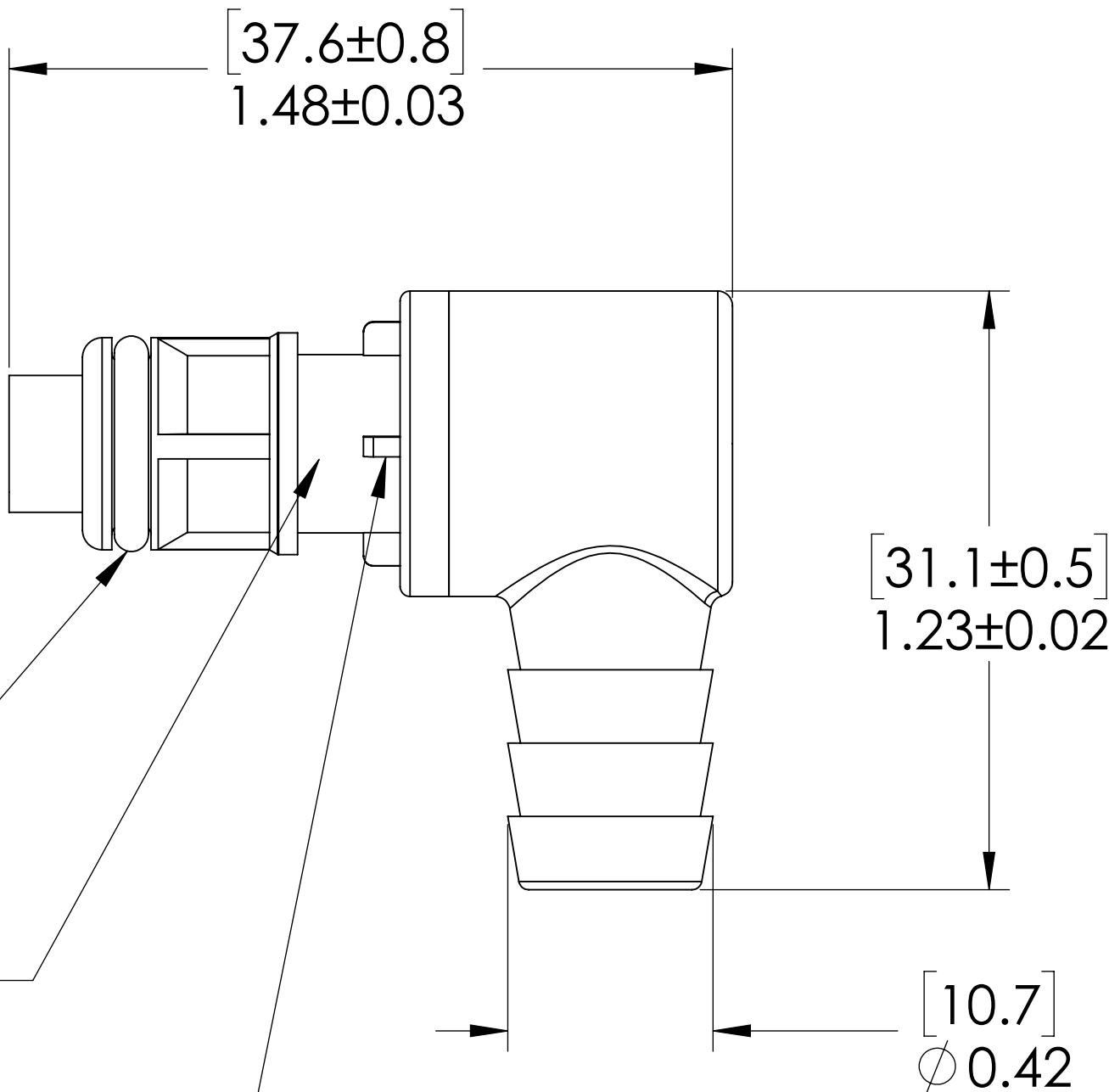

NOTES:

1. MATERIAL: POLYPROPYLENE
2. COLOR: LIGHT GRAY
3. O-RING MATERIAL: EPDM
4. O-RINGS LUBRICATED WITH FOOD GRADE SILICONE OIL, 350 CST.

FOR REFERENCE ONLY

UNLESS OTHERWISE SPECIFIED:				LINKTECH		
DIMENSIONS ARE IN INCHES TOLERANCES: FRACTIONAL ±1/32 ANGULAR, MACH ±0.5 ONE PLACE DECIMAL ±0.1 TWO PLACE DECIMAL ±0.01 THREE PLACE DECIMAL ±0.005 TWO PLACE DUAL (mm) [±0.12]	DRAWN	RDA	7/10/2017	PART NO: 50PPV-PE4-06		
	CHECKED	HRC	7/10/2017			
	ENG APPR.	HRC	03-08-18	DESCRIPTION: LinkTech 50PP Series Elbow Male, Valved, 375 HB, Polypropylene		
	MFG APPR.	BDB	03-08-18			
PROPRIETARY AND CONFIDENTIAL THE INFORMATION CONTAINED IN THIS DRAWING IS THE SOLE PROPERTY OF LINKTECH LLC. ANY REPRODUCTION OR DISCLOSURE IN PART OR AS A WHOLE WITHOUT THE WRITTEN PERMISSION OF LINKTECH LLC IS STRICTLY PROHIBITED.	PURCHASING	RK	03-08-18	SIZE	DWG. NO.	REV
	COMMENTS:			C	50PP500030	A
	SCALE: NTS		WEIGHT:	SHEET 1 OF 1		