

REVISIONS						
SHEET	ZONE	REV.	ECO	DESCRIPTION	DATE	APPROVED
1	ALL	A	50257	INITIAL RELEASE	6/28/2018	HRC

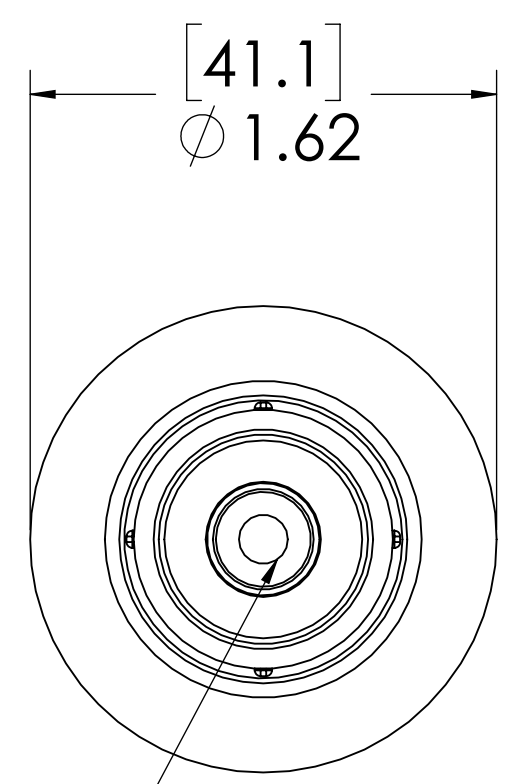

VALVE,  
(POLYPROPYLENE)

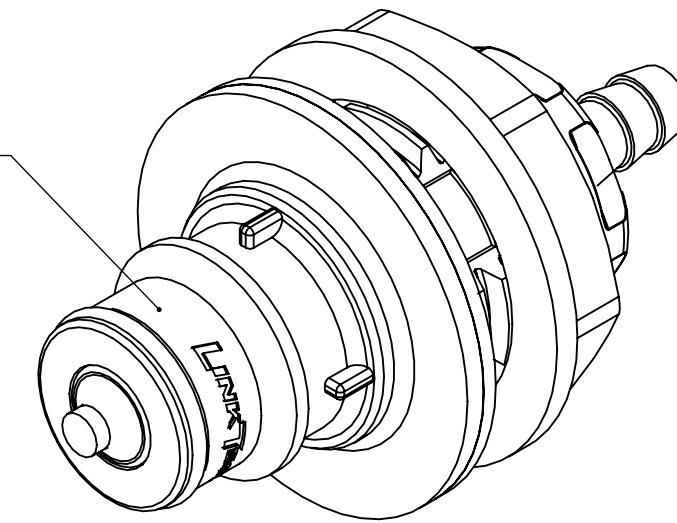
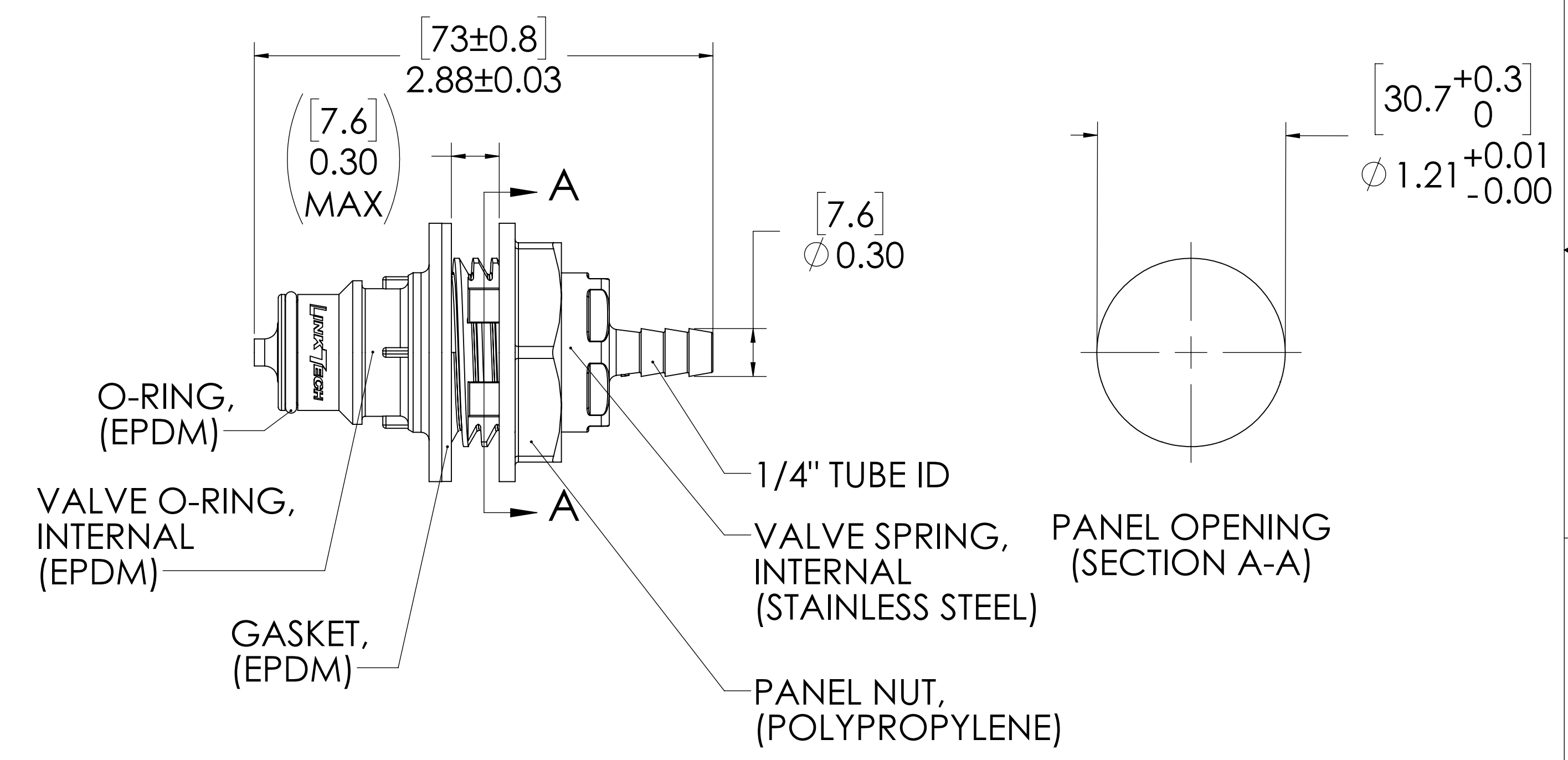

O-RING,  
(EPDM)

VALVE O-RING,  
INTERNAL  
(EPDM)

GASKET,  
(EPDM)

1/4" TUBE ID

VALVE SPRING,  
INTERNAL  
(STAINLESS STEEL)

PANEL NUT,  
(POLYPROPYLENE)

PANEL OPENING  
(SECTION A-A)

- NOTES:**
1. MATERIAL: POLYPROPYLENE
  2. COLOR: GREY
  3. O-RING MATERIAL: EPDM
  4. O-RINGS LUBRICATED WITH FOOD GRADE SILICONE OIL, 350 CST.

**FOR REFERENCE ONLY**

<small>UNLESS OTHERWISE SPECIFIED: DIMENSIONS ARE IN INCHES TOLERANCES: FRACTIONAL ± 1/32 ANGULAR: MACH ± 0.5 BEND ± 2 ONE PLACE DECIMAL ± 0.1 TWO PLACE DECIMAL ± 0.01 THREE PLACE DECIMAL ± 0.005 TWO PLACE DUAL (mm) [± 0.12]</small>	DRAWN	CGS	12/21/17	
	CHECKED	HRC	12/21/17	
	ENG APPR.	HRC	6/28/18	
	MFG APPR.	BDB	6/28/18	
PRODUCTION	LS	6/28/18		<b>PART NO:</b> 60PPV-PE3-04 <b>DESCRIPTION:</b> LinkTech 60PP Series Panel Mt. Male, Valved 1/4" HB, Polypropylene
<small>THE INFORMATION CONTAINED IN THIS DRAWING IS THE SOLE PROPERTY OF LINKTECH LLC. ANY REPRODUCTION OR DISCLOSURE IN PART OR AS A WHOLE WITHOUT THE WRITTEN PERMISSION OF LINKTECH LLC IS STRICTLY PROHIBITED.</small>	COMMENTS:			<b>SIZE</b> DWG. NO. REV <b>C</b> 60PP600142 <b>A</b>
SCALE: NTS		WEIGHT:	SHEET 1 OF 1	