

REVISIONS			
REV.	DESCRIPTION	DATE	APPROVED
A	INITIAL RELEASE	12-22-22	FJL

INSTRUMENT QUALITY PART. NO
PARTING LINE PERMITTED ON THIS
CONICAL SURFACE.

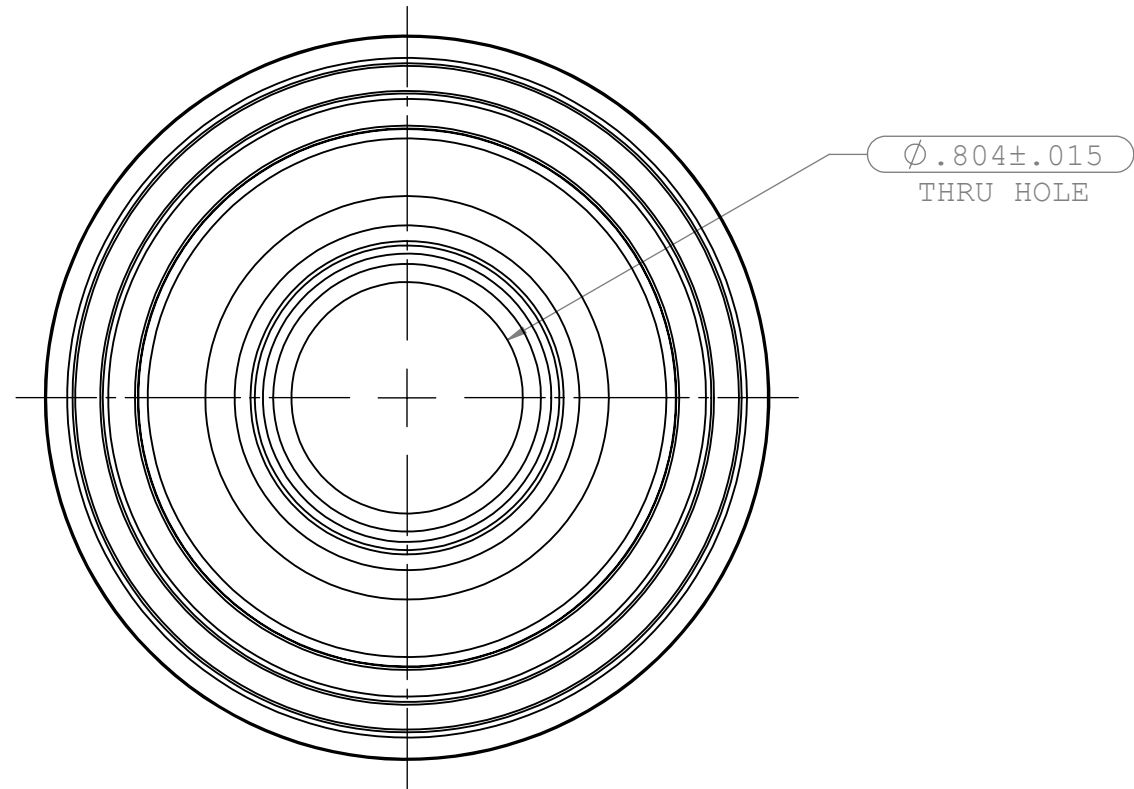
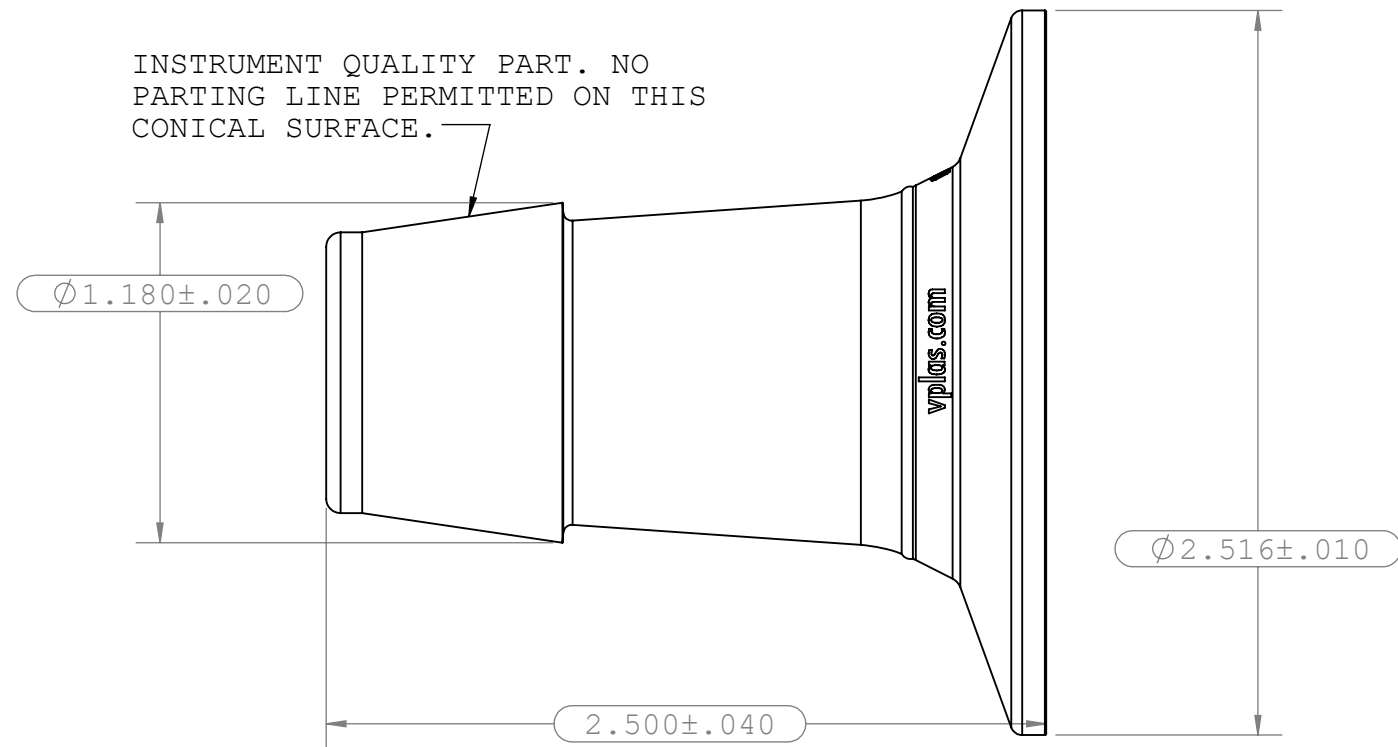

- NOTES:
- FOR ADDITIONAL DETAILS, PLEASE CONTACT VP PRODUCT DEVELOPMENT
 - DIMENSIONS MARKED $\text{---}\ast\text{---}$ ARE CONTROL DIMENSIONS
 - ALL EXTERIOR SURFACES HAVE A MAXIMUM OF 20 RA MICROINCH SURFACE FINISH
 - ALL INTERIOR SURFACES HAVE A MAXIMUM OF 15 RA MICROINCH SURFACE FINISH
 - VALUE PLASTICS SFMX SERIES FERRULES ARE DESIGNED TO COMPLY WITH ASME BPE-2022 TABLE DT-7.1-2 HYGIENIC CLAMP FERRULE STANDARD DIMENSIONS & TOLERANCES; DT-9.3-1 HYGIENIC CLAMP FERRULE: DESIGN CRITERIA.
 - ALL INTERIOR AND EXTERIOR SURFACE FINISHES COMPLY WITH ASME BPE-2022 TABLE SF-3.4-1 SFP2 RA READINGS FOR POLYMERIC PRODUCT CONTACT SURFACES

UNLESS OTHERWISE SPECIFIED DIMENSIONS ARE IN INCHES TOLERANCES ARE: FRACTIONS DECIMAL ANGULAR ± .XX ±.01 ± 1° .XXX ±.005 .XXXX ±.001 DO NOT SCALE DRAWING		VALUE PLASTICS, INC						
		PART NUMBER: SFM2X6110						
		DESCRIPTION: Sanitary Fitting, 2" Maxi Flange to 600 Series Barb, 1" (25.4 mm) Tubing ID						
DRAWN BY: Andrew.Watts		DATE: 1/5/2023		SIZE: B	SCALE: NTS	VER: 	DWG. NO. 1350197	REV A
NEW PRODUCT DEVELOPMENT MGR: Frank.Lombardi				© 2014 VALUE PLASTICS, INC				SHEET: 1 OF 1

FOR REFERENCE ONLY