

NOTES: FOR ADDITIONAL DETAILS, PLEASE CONTACT VP NEW PRODUCT DEVELOPMENT
DIMENSIONS MARKED  ARE CONTROL DIMENSIONS

REVISIONS			
REV.	DESCRIPTION	DATE	APPROVED
A	INITIAL RELEASE FOR PRODUCTION	05-20-21	FJL

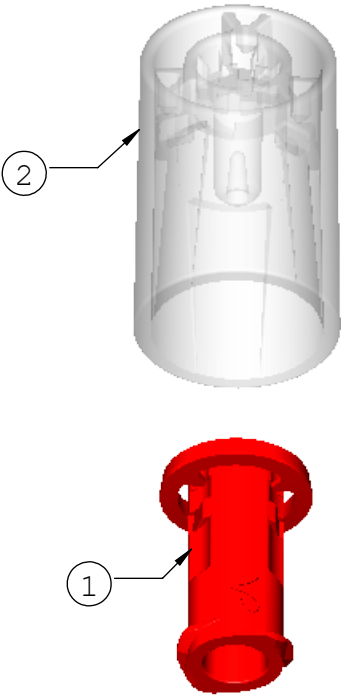
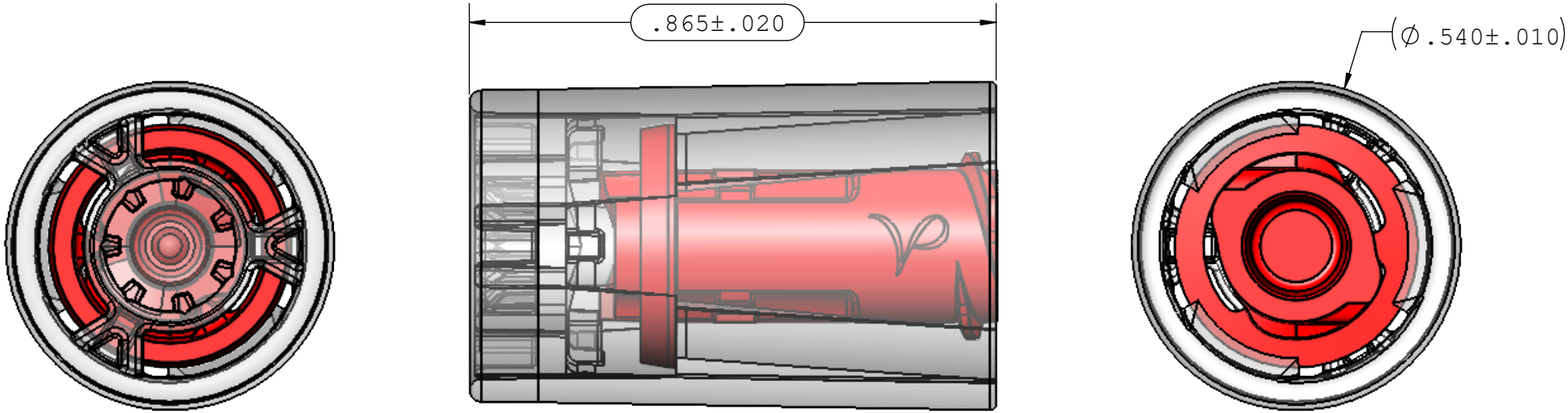

Assembly P/N	Assembly Description	Component	Item #	Component Material	Component Description	Qty
TEFTLLCG-001	Non-sterile	CF1058-6013	1	Red Polypropylene	General Purpose Breakaway Luer Cap, Insert, Female Luer Lock	1
		CF1059-9024	2	Tinted Polycarbonate	General Purpose Breakaway Luer Cap, Shroud	1

UNLESS OTHERWISE SPECIFIED DIMENSIONS ARE IN INCHES TOLERANCES ARE: FRACTIONS DECIMAL ANGULAR ± ±.XX ±.01 ± 1° .XXX ±.005 .XXXX ±.001 DO NOT SCALE DRAWING			VALUE PLASTICS, INC				
			PART NUMBER: TEFTLLCG				
			DESCRIPTION: General Purpose Breakaway Female Luer Cap				
DRAWN BY: Pete.Lewis		DATE: 12/20/2021	SIZE: B	SCALE: NTS	VER: 	DWG. NO. 1276215	REV A
MANAGER: Frank.Lombardi			© 2014 VALUE PLASTICS, INC				SHEET: 1 OF 1

FOR REFERENCE ONLY