

NOTES: FOR ADDITIONAL DETAILS, PLEASE CONTACT VP CUSTOMER SERVICE
DIMENSIONS MARKED ARE CONTROL DIMENSIONS

REVISIONS			
REV.	DESCRIPTION	DATE	APPROVED
A	INITIAL RELEASE	02-11-03	
B	CO 018 DRAFTING UPDATE	08-18-05	RICK C.
C	ECO 401	10-08-19	FJL

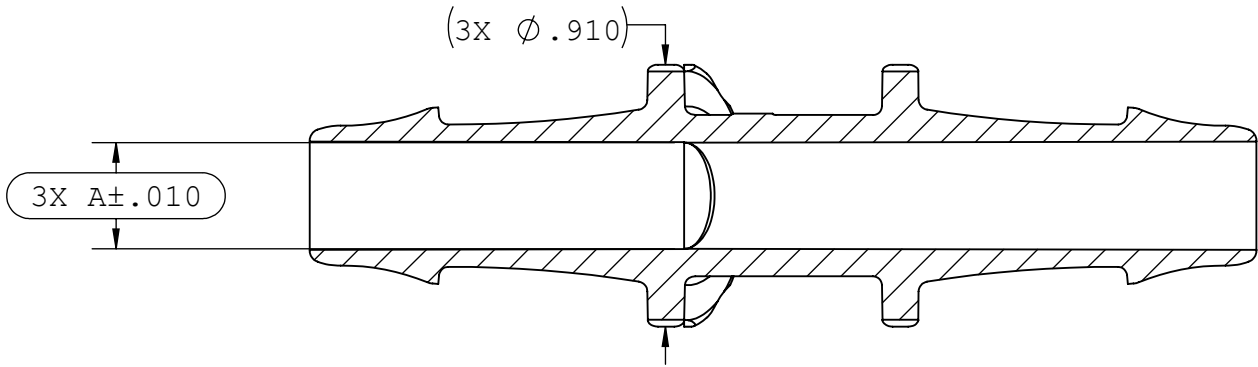
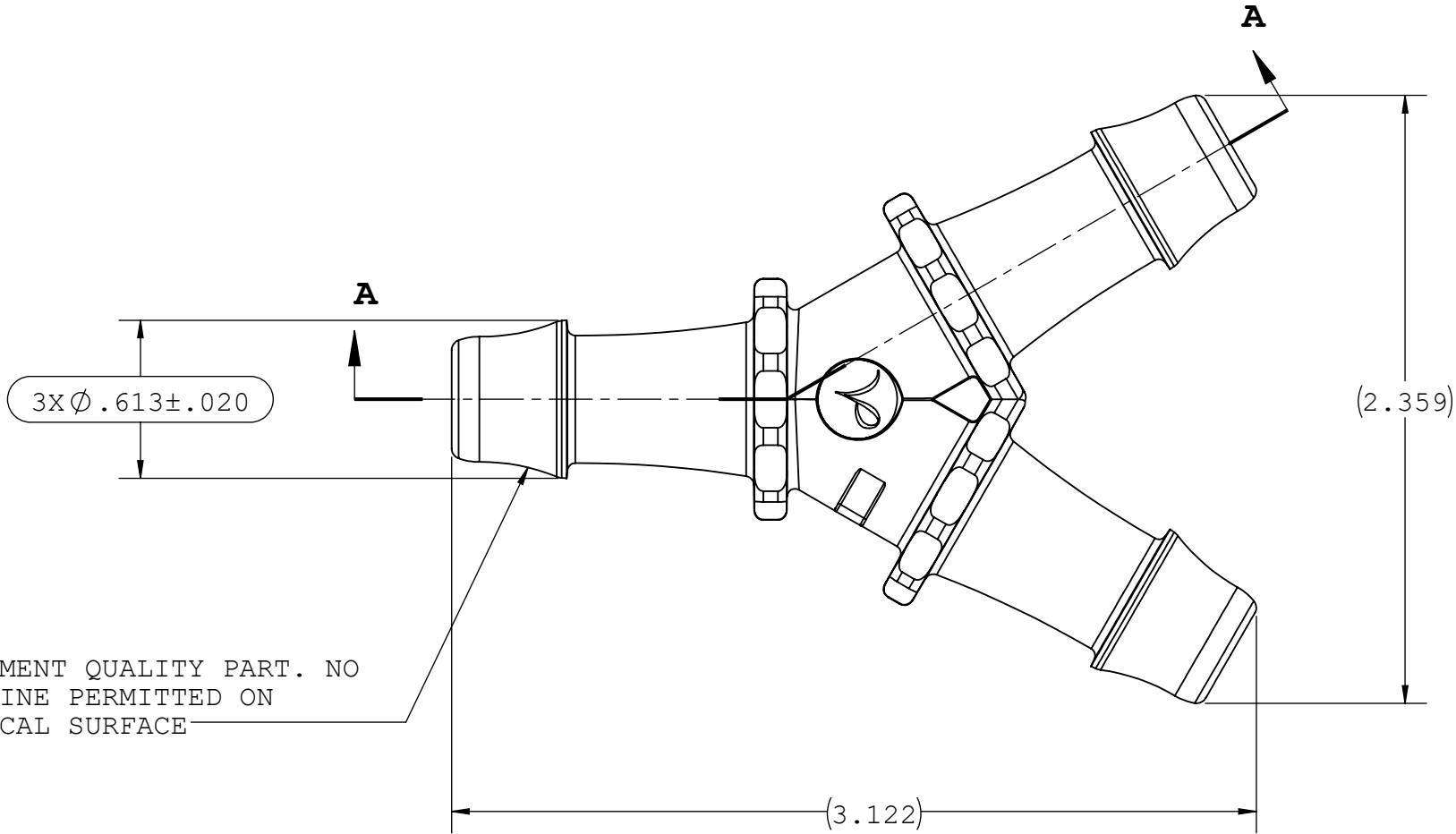

SECTION A-A

FEATURE MAY
OR MAY NOT
BE PRESENT

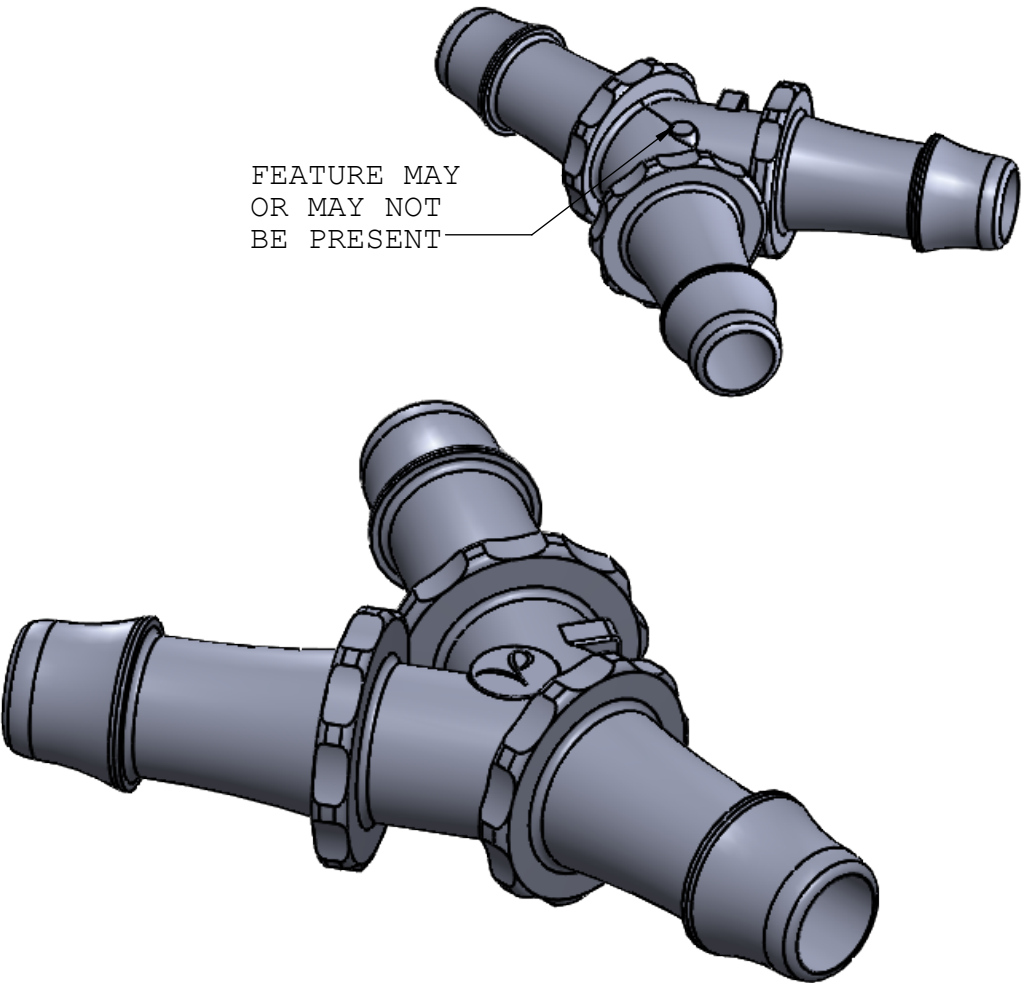

Dimension	Material Specific Tolerances							
	Acetal	Nylon	PP	ABS	PC	PVC	Polysulfone	Kynar
A	.359	.359	.371	.359	.371	.359	.359	.359
B								
C								
D								
E								
F								

UNLESS OTHERWISE SPECIFIED DIMENSIONS ARE IN INCHES TOLERANCES ARE: FRACTIONS DECIMAL ANGULAR ± .XX ±.01 ± 1° .XXX ±.005 .XXXX ±.001 DO NOT SCALE DRAWING				VALUE PLASTICS, INC			
				PART NUMBER: Y080			
DRAWN BY: BRYCE HIRSCHFELD				DESCRIPTION: Y CONNECTOR WITH 500 SERIES BARBS, 1/2" (12.7 mm) ID TUBING			
DATE: 10/8/2019				SIZE: B	SCALE: NTS	VER: 	DWG. NO. 1006899
MANAGER: LOU HUADONG				REV C			
© 2014 VALUE PLASTICS, INC						SHEET: 1 OF 1	

FOR REFERENCE ONLY